

PRESIDENT'S OFFICE
 BASIS OF DESIGN ELECTIVE ELEMENTS WOOD
 500 SQUARE FEET



Project: OFFICE STANDARDS

Account Executive: L. ROEMER
 Designer: KJW
 Project Manager:

Project Folder: 170666
 Hedberg Order #:

Plot Date:
 Revision Dates: 4/28/17
 7/12/17
 12/7/17
 00/00/00
 00/00/00
 00/00/00

General Notes:

Not for construction

All structural, mechanical and electrical engineering is the responsibility of others.

All furniture and design drawings are in confidence and dissemination may not be made without prior written consent of NBS. All common law rights of copyright and otherwise are hereby specifically reserved.

Final furniture fit and placement is subject to any variation from this plan due to construction changes, field conditions, material differences or changes required for any reason with notification to NBS.

If NBS did not design this project, NBS does not assume responsibility for the design, specification of parts or application of products included in this bid. NBS has only responded to the pricing request for the specifications provided.



5160 Alliance Rd Bay City, MI 48706
 p: 989.895.8574 f: 989.895.8545
 www.navbus.com

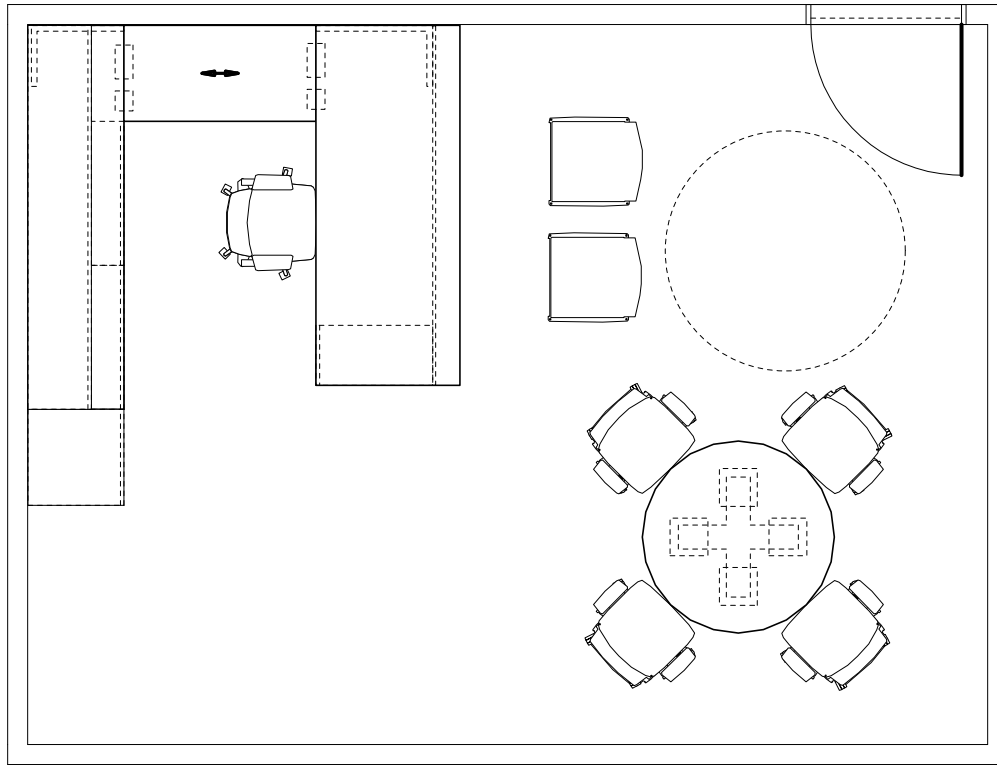

VICE PRESIDENT'S OFFICE
 BASIS OF DESIGN ELECTIVE ELEMENTS WOOD
 300 SQUARE FEET



Account Executive: L. ROEMER
 Designer: KJW
 Project Manager:

Project Folder: 170666
 Hedberg Order #:

Plot Date:
 Revision Dates: 4/28/17
 12/7/17
 00/00/00
 00/00/00
 00/00/00
 00/00/00

General Notes:

Not for construction
 All structural, mechanical and electrical engineering is the responsibility of others.
 All furniture and design drawings are in confidence and dissemination may not be made without prior written consent of NBS. All common law rights of copyright and otherwise are hereby specifically reserved.
 Final furniture fit and placement is subject to any variation from this plan due to construction changes, field conditions, material differences or changes required for any reason with notification to NBS.
 If NBS did not design this project, NBS does not assume responsibility for the design, specification of parts or application of products included in this bid. NBS has only responded to the pricing request for the specifications provided.



5160 Alliance Rd Bay City, MI 48706
 p: 989.895.8574 f: 989.895.8545
 www.navbus.com

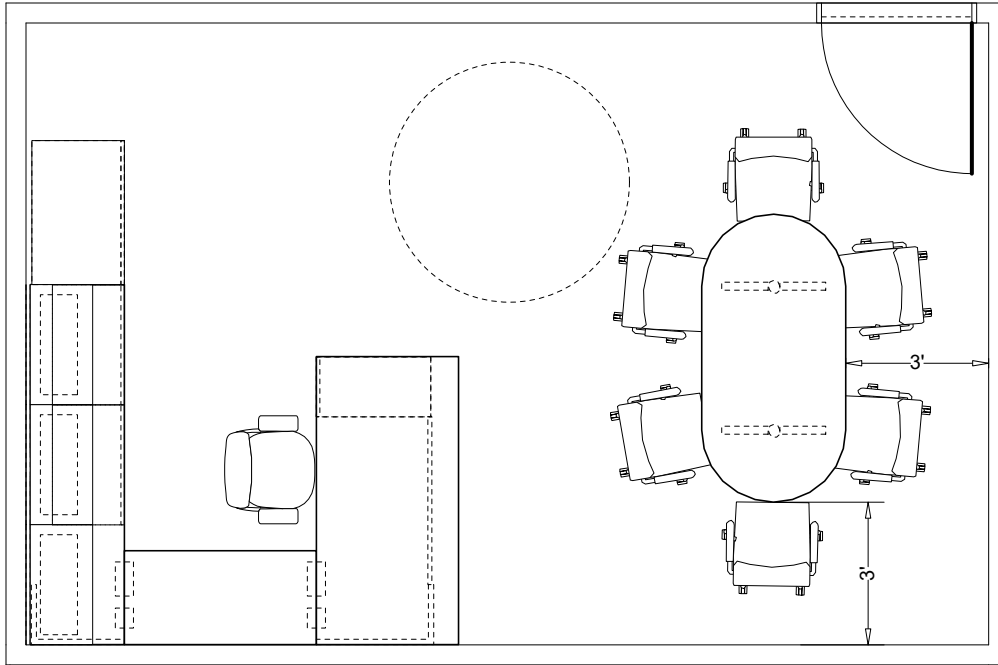

DEAN'S OFFICE
BASIS OF DESIGN ANSWER UNIVERSAL
220 SQUARE FEET



Project: OFFICE STANDARDS

Account Executive: L. ROEMER
Designer: KJW
Project Manager:

Project Folder: 170666
Hedberg Order #:

Plot Date:
Revision Dates: 4/28/17
12/7/17
00/00/00
00/00/00
00/00/00
00/00/00

General Notes:

Not for construction

All structural, mechanical and electrical engineering is the responsibility of others.

All furniture and design drawings are in confidence and dissemination may not be made without prior written consent of NBS. All common law rights of copyright and otherwise are hereby specifically reserved.

Final furniture fit and placement is subject to any variation from this plan due to construction changes, field conditions, material differences or changes required for any reason with notification to NBS.

If NBS did not design this project, NBS does not assume responsibility for the design, specification of parts or application of products included in this bid. NBS has only responded to the pricing request for the specifications provided.



5160 Alliance Rd Bay City, MI 48706
p: 989.895.8574 f: 989.895.8545
www.navbus.com

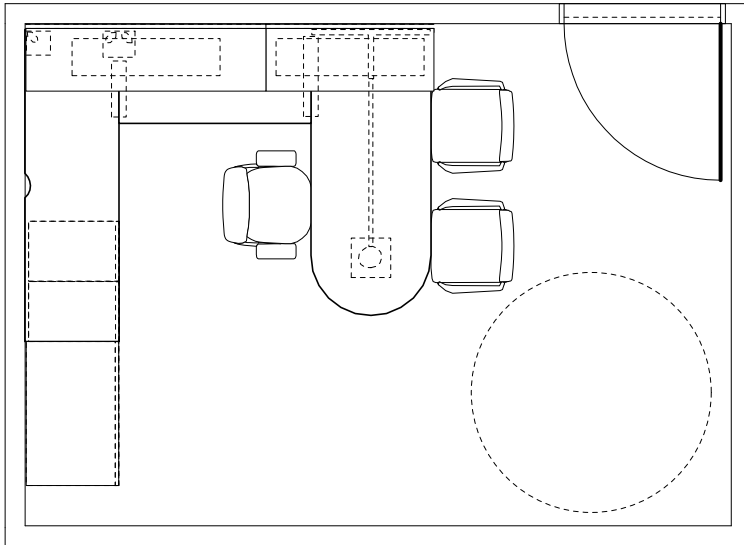

DIRECTOR/DEPARTMENT CHAIR OFFICE
 BASIS OF DESIGN ANSWER UNIVERSAL
 150 SQUARE FEET



Project: OFFICE STANDARDS

Account Executive: L. ROEMER
 Designer: KJW
 Project Manager:

Project Folder: 170666
 Hedberg Order #:

Plot Date:
 Revision Dates: 4/28/17
 7/12/17
 12/7/17
 00/00/00
 00/00/00
 00/00/00

General Notes:

Not for construction

All structural, mechanical and electrical engineering is the responsibility of others.

All furniture and design drawings are in confidence and dissemination may not be made without prior written consent of NBS. All common law rights of copyright and otherwise are hereby specifically reserved.

Final furniture fit and placement is subject to any variation from this plan due to construction changes, field conditions, material differences or changes required for any reason with notification to NBS.

If NBS did not design this project, NBS does not assume responsibility for the design, specification of parts or application of products included in this bid. NBS has only responded to the pricing request for the specifications provided.



5160 Alliance Rd Bay City, MI 48706
 p: 989.895.8574 f: 989.895.8545
 www.navbus.com

220 SQUARE FEET

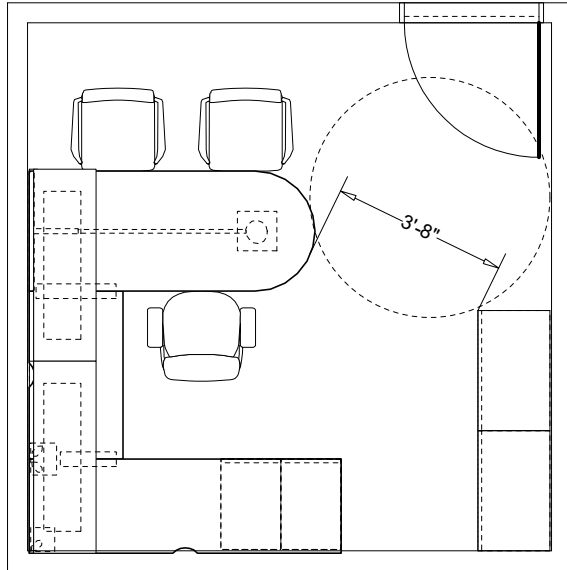

PROFESSIONAL & ADMIN. OFFICE
BASIS OF DESIGN ANSWER UNIVERSAL
120 SQUARE FEET



Project: OFFICE STANDARDS

Account Executive: L. ROEMER
Designer: KJW
Project Manager:

Project Folder: 170666
Hedberg Order #:

Plot Date:
Revision Dates: 4/28/17
12/7/17
00/00/00
00/00/00
00/00/00
00/00/00

General Notes:

Not for construction

All structural, mechanical and electrical engineering is the responsibility of others.

All furniture and design drawings are in confidence and dissemination may not be made without prior written consent of NBS. All common law rights of copyright and otherwise are hereby specifically reserved.

Final furniture fit and placement is subject to any variation from this plan due to construction changes, field conditions, material differences or changes required for any reason with notification to NBS.

If NBS did not design this project, NBS does not assume responsibility for the design, specification of parts or application of products included in this bid. NBS has only responded to the pricing request for the specifications provided.



5160 Alliance Rd Bay City, MI 48706
p: 989.895.8574 f: 989.895.8545
www.navbus.com

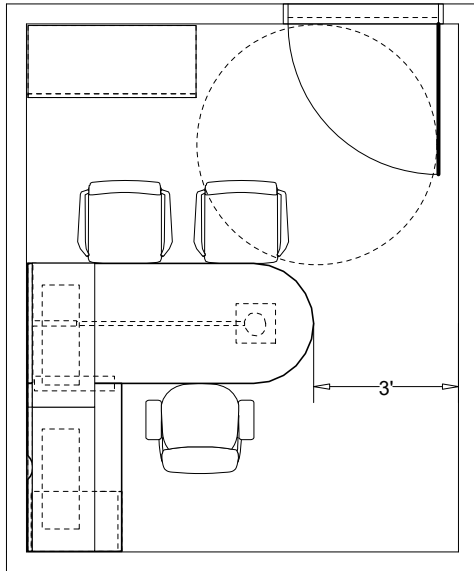

FACULTY OFFICE
 BASIS OF DESIGN ANSWER UNIVERSAL
 100 SQUARE FEET



Project: OFFICE STANDARDS

Account Executive: L. ROEMER
 Designer: KJW
 Project Manager:

Project Folder: 170666
 Hedberg Order #:

Plot Date:
 Revision Dates: 4/28/17
 12/7/17
 00/00/00
 00/00/00
 00/00/00
 00/00/00

General Notes:

Not for construction

All structural, mechanical and electrical engineering is the responsibility of others.

All furniture and design drawings are in confidence and dissemination may not be made without prior written consent of NBS. All common law rights of copyright and otherwise are hereby specifically reserved.

Final furniture fit and placement is subject to any variation from this plan due to construction changes, field conditions, material differences or changes required for any reason with notification to NBS.

If NBS did not design this project, NBS does not assume responsibility for the design, specification of parts or application of products included in this bid. NBS has only responded to the pricing request for the specifications provided.



5160 Alliance Rd Bay City, MI 48706
 p: 989.895.8574 f: 989.895.8545
 www.navbus.com

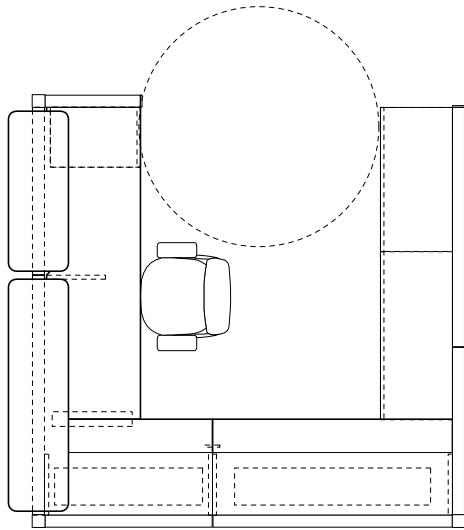

O.P. OFFICE
 BASIS OF DESIGN ANSWER UNIVERSAL
 80 SQUARE FEET



Project: OFFICE STANDARDS

Account Executive: L. ROEMER
 Designer: KJW
 Project Manager:

Project Folder: 170666
 Hedberg Order #:

Plot Date:
 Revision Dates: 4/28/17
 12/7/17
 00/00/00
 00/00/00
 00/00/00
 00/00/00

General Notes:

Not for construction

All structural, mechanical and electrical engineering is the responsibility of others.

All furniture and design drawings are in confidence and dissemination may not be made without prior written consent of NBS. All common law rights of copyright and otherwise are hereby specifically reserved.

Final furniture fit and placement is subject to any variation from this plan due to construction changes, field conditions, material differences or changes required for any reason with notification to NBS.

If NBS did not design this project, NBS does not assume responsibility for the design, specification of parts or application of products included in this bid. NBS has only responded to the pricing request for the specifications provided.



5160 Alliance Rd Bay City, MI 48706
 p: 989.895.8574 f: 989.895.8545
 www.navbus.com

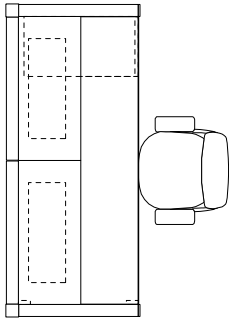

STUDENT WORKSTATION
 BASIS OF DESIGN ANSWER UNIVERSAL
 60 SQUARE FEET



Project: OFFICE STANDARDS

Account Executive: L. ROEMER
 Designer: KJW
 Project Manager:

Project Folder: 170666
 Hedberg Order #:

Plot Date:
 Revision Dates: 4/28/17
 12/7/17
 00/00/00
 00/00/00
 00/00/00
 00/00/00

General Notes:

Not for construction

All structural, mechanical and electrical engineering is the responsibility of others.

All furniture and design drawings are in confidence and dissemination may not be made without prior written consent of NBS. All common law rights of copyright and otherwise are hereby specifically reserved.

Final furniture fit and placement is subject to any variation from this plan due to construction changes, field conditions, material differences or changes required for any reason with notification to NBS.

If NBS did not design this project, NBS does not assume responsibility for the design, specification of parts or application of products included in this bid. NBS has only responded to the pricing request for the specifications provided.



5160 Alliance Rd Bay City, MI 48706
 p: 989.895.8574 f: 989.895.8545
 www.navbus.com

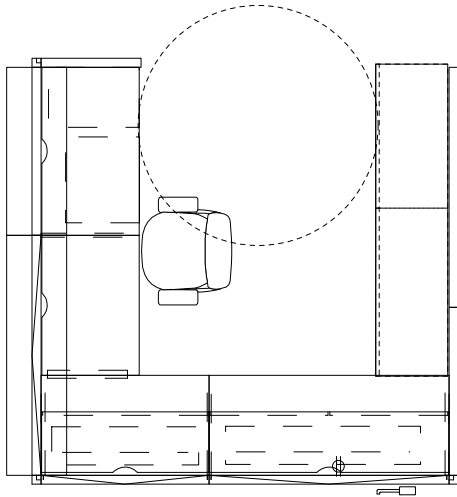

OPTIONAL O.P. OFFICE
 BASIS OF DESIGN SERIES 9000
 80 SQUARE FEET



Project: OFFICE STANDARDS

Account Executive: L. ROEMER
 Designer: KJW
 Project Manager:

Project Folder: 170666
 Hedberg Order #:

Plot Date:
 Revision Dates: 4/28/17
 12/7/17
 00/00/00
 00/00/00
 00/00/00
 00/00/00

General Notes:

Not for construction

All structural, mechanical and electrical engineering is the responsibility of others.

All furniture and design drawings are in confidence and dissemination may not be made without prior written consent of NBS. All common law rights of copyright and otherwise are hereby specifically reserved.

Final furniture fit and placement is subject to any variation from this plan due to construction changes, field conditions, material differences or changes required for any reason with notification to NBS.

If NBS did not design this project, NBS does not assume responsibility for the design, specification of parts or application of products included in this bid. NBS has only responded to the pricing request for the specifications provided.



5160 Alliance Rd Bay City, MI 48706
 p: 989.895.8574 f: 989.895.8545
 www.navbus.com

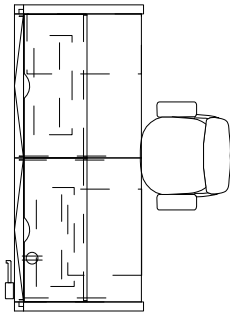

OPTIONAL STUDENT WORKSTATION
 BASIS OF DESIGN SERIES 9000
 60 SQUARE FEET



Project: OFFICE STANDARDS

Account Executive: L. ROEMER
 Designer: KJW
 Project Manager:

Project Folder: 170666
 Hedberg Order #:

Plot Date:
 Revision Dates: 4/28/17
 12/7/17
 00/00/00
 00/00/00
 00/00/00
 00/00/00

General Notes:

Not for construction

All structural, mechanical and electrical engineering is the responsibility of others.

All furniture and design drawings are in confidence and dissemination may not be made without prior written consent of NBS. All common law rights of copyright and otherwise are hereby specifically reserved.

Final furniture fit and placement is subject to any variation from this plan due to construction changes, field conditions, material differences or changes required for any reason with notification to NBS.

If NBS did not design this project, NBS does not assume responsibility for the design, specification of parts or application of products included in this bid. NBS has only responded to the pricing request for the specifications provided.



5160 Alliance Rd Bay City, MI 48706
 p: 989.895.8574 f: 989.895.8545
 www.navbus.com